

AVENUE

SIMMAT

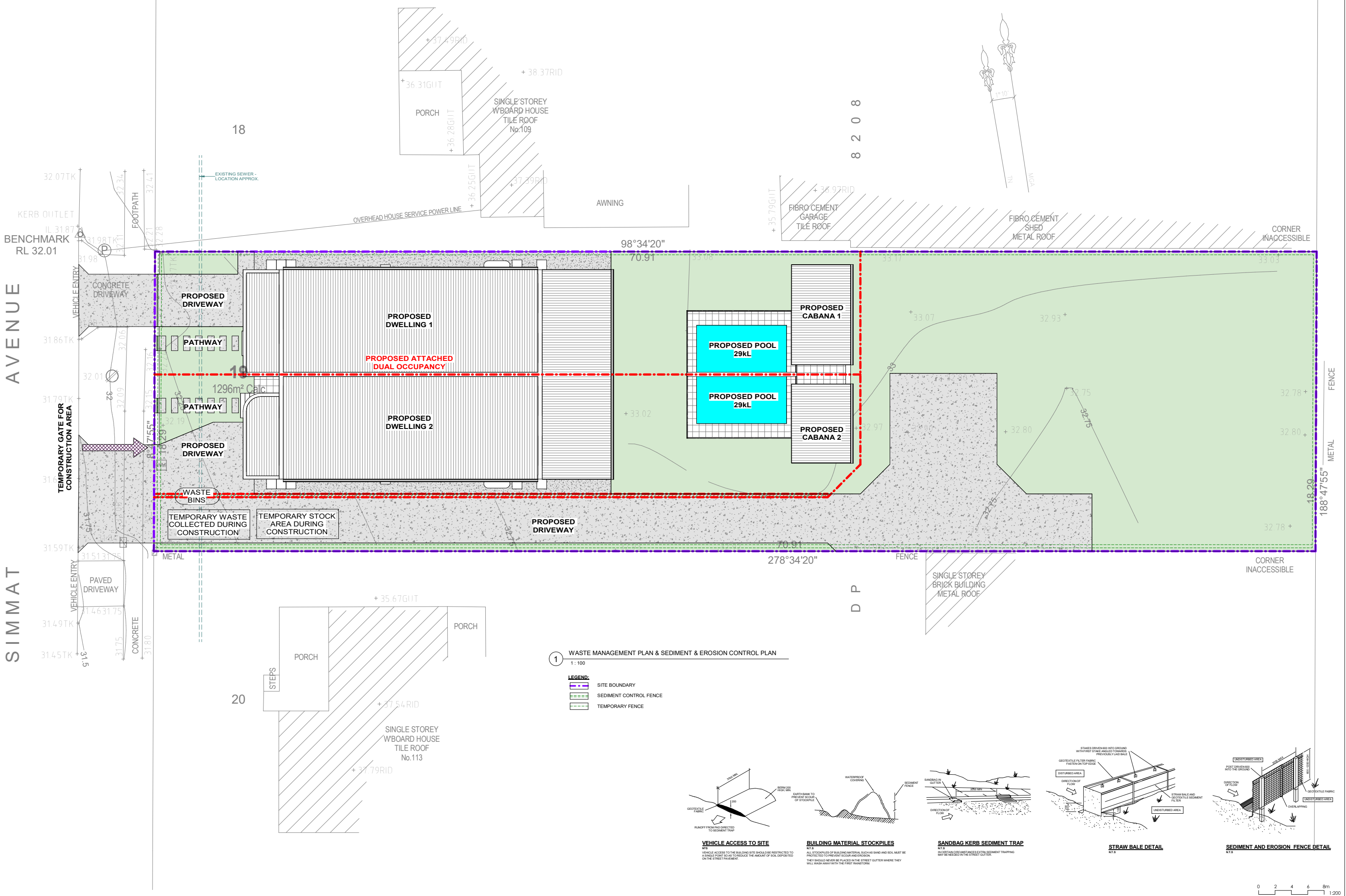

1 WASTE MANAGEMENT PLAN & SEDIMENT & EROSION CONTROL PLAN

1: 100

LEGEND:

- SITE BOUNDARY
- SEDIMENT CONTROL FENCE
- TEMPORARY FENCE

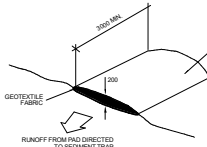

VEHICLE ACCESS TO SITE
N.T.S.
VEHICLE ACCESS TO THE BUILDING SITE SHOULD BE RESTRICTED TO A SINGLE POINT SO AS TO REDUCE THE AMOUNT OF SOIL DEPOSITED ON THE STREET PAVEMENT.

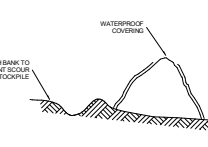

BUILDING MATERIAL STOCKPILES
N.T.S.
ALL STOCKPILES OF BUILDING MATERIAL SUCH AS SAND AND SOIL MUST BE PROTECTED TO PREVENT SOIL AND EROSION. THEY SHOULD NEVER BE PLACED IN THE STREET GUTTER WHERE THEY WILL WASH AWAY WITH THE FIRST RAINSTORM.

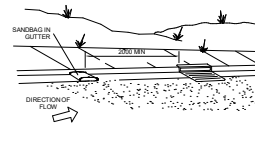

SANDBAG KERB SEDIMENT TRAP
N.T.S.
IN CERTAIN CIRCUMSTANCES EXTRA SEDIMENT TRAPPING MAY BE NEEDED IN THE STREET GUTTER.

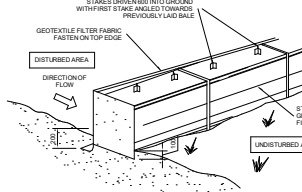

STRAW BALE DETAIL
N.T.S.

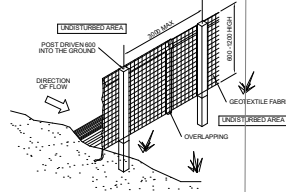

SEDIMENT AND EROSION FENCE DETAIL
N.T.S.

REV	DATE	DESCRIPTION
A	13.07.2022	ISSUED FOR DA

COPYRIGHT
All rights reserved.
These drawings, plans and specifications and the copyright are the property of Nemco Design and must not be used, reproduced or copied wholly or in part without the written permission of Nemco Design.

NEMCO DESIGN
STRUCTURAL ENGINEERING
& ARCHITECTURAL DESIGN

ADDRESS:
111 SIMMAT AVE, CONDELL PARK
NSW 2140
TEL: 02 9618 8888
WWW.NEMCODESIGN.COM.AU

PROPOSED DEMOLITION OF EXISTING STRUCTURES AND REMOVAL OF EXISTING TREES. PROPOSED BATTLE AXE SUBDIVISION INTO 2 LOTS AND CONSTRUCTION OF AN ATTACHED DUAL OCCUPANCY WITH SWIMMING POOLS ON FRONT LOT.
111 SIMMAT AVE, CONDELL PARK
LOT 19, SEC 2, DP 8208
WASTE MANAGEMENT PLAN & SEDIMENT & EROSION CONTROL PLAN

PRO NUMBER: 21940
DESIGN NUMBER: A01.05
DATE: 13.07.2022
DRAWN BY: A.N.
SCALE: AS SHOWN



0 2 4 6 8m
1:200

21/07/2022 10:15:30 AM